

BARS

COLD DRAWN RIBBED B500A (DE500BS)

Diameter (mm)	Minimum length (m)	Maximum length (m)	Weight (kg/m)
4	0,10	14	0,099
5	0,10	14	0,154
6	0,10	14	0,222
7	0,10	14	0,302
8	0,10	14	0,395
9	0,10	14	0,499
10	0,10	14	0,617
11	0,10	14	0,746
12	0,10	14	0,888
13	0,20	14	1,042
14	0,20	14	1,208
16	0,50	14	1,578

COMMENTS

- Diameters ≤ 5 are quality B500 instead of B500A and are not certified for any country
- Only diameters 6, 8, 10 and 12 are certified for Germany
- Diameter 13 is not certified for the Netherlands
- Different diameters upon request

ADDITIONAL INFORMATION

- Bundle weights: standard $\pm 1000\text{kg}$, unless agreed otherwise
- Tolerance: we can cut accurately to $-0/+0\text{mm}$
- All our bundles are vibrated so that the bars lie side by side

GRADE B500A - DE500BS

Mechanical characteristics	Yield strength Re (Mpa)	Stress ratio Rm/Re		Total elongation at max force Agt %	
		$5 \leq d \leq 5.5$	$d \geq 6$	$5 \leq d \leq 5.5$	$d \geq 6$
Minimum characteristic value Cv	500	1,03	1,05	2,0	3,0

PRODUCERS MARK

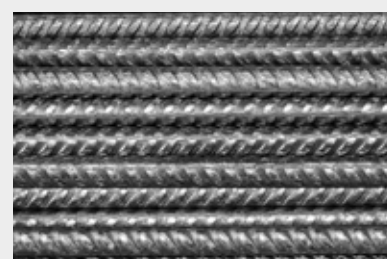
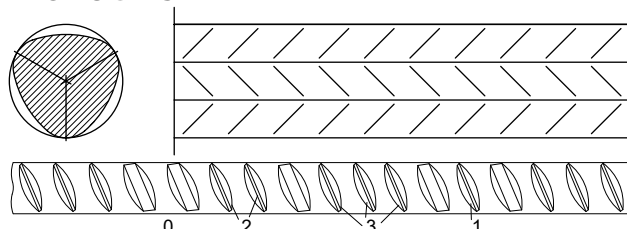

Certificates Intersig NV



Certificates Van Merksteijn International



For the up to date scope on our certificates, we would like to refer you to our website.